

General Information	
Ministerial Decision Type	Drafting Instructions: Subordinate Legislation (Regulations/Order)
Report Title	Road Traffic (St. Lawrence) (Jersey) Order 1990
Minister	Infrastructure
Signatory	Minister
Lead Department	Infrastructure, Housing and Environment (IHE)
Lead Directorate	Operations and Transport (IHE)
Ministerial Decision Summary: Public or <a href="#">Absolutely/Qualified</a> Exempt	Public Select if more than one Absolutely/Qualified Exemption.
Date decision made if different to date 'Ministerial Decision Summary' signed.	11/04/2023
Report and Supplemental Report Details	
Report Author	Project Manager - Infrastructure
Date of Report	26/05/2023
Supplementary Report Title <i>(If applicable)</i>	Insert Supplemental Report Title.
Supplementary Report Author <i>(If applicable)</i>	Insert Official Title Only.
Date of Supplementary Report <i>(If applicable)</i>	Select Date of Supplemental Report.
Ministerial Decision Report: Public or <a href="#">Absolutely/Qualified</a> Exempt	Public Select if more than one Absolutely/Qualified Exemption.
Relevant Case/Application/URN <i>(Only complete if making a decision related to an appeal/case/application)</i>	Insert Relevant Case/Application.
Relevant Proposition Number <i>(Only complete if presenting Comments or if lodging an Amendment)</i>	Insert P. number.
Relevant Scrutiny Report <i>(Only complete if presenting a ministerial response)</i>	Insert S.R. number.
Associated Law(s) and/or Subordinate Legislation	Road Traffic (St. Lawrence) (Jersey) Order 1990
Action required if recommendation agreed	Principal Legislative Drafter to be requested to draft legislation.

Resource Implications	There are no new financial and/or manpower implications.
-----------------------	--

### Introduction

The Minister for Infrastructure is asked to approve an Amendment to the Road Traffic (St. Lawrence) (Jersey) Order 1990 to introduce a 6 foot 6 inch width restriction on Sandybrook Lane as requested by the Connétable of St. Lawrence, to make changes to parking on La Rue de Haut in support of improvements being carried out by the Department by Bel Royal School and to add a new prohibition of waiting area on La Route de St. Jean that has been recommended by the Road Safety Review Panel.

### Recommendation

To request the Principal Legislative Drafter to draft the necessary legislation.

Only insert text if 'Other' selected above.

### Detail

The Connétable of St. Lawrence has requested that Sandybrook Lane have a restriction of no traffic over 6 foot 6 inch width applied to it. The road already has a one-way traffic flow from the junction with La Valle de St. Pierre in a north westerly direction and a speed restriction of 20 mph applied. (Appendix 1)

The Connétable has noted concerns from both members of the parish Roads Committee and the parish Honorary Police over the number of large vehicles which are using this small road as an alternative to the Beaumont junction. The road is used by pedestrians in both directions and they are put at increased risk by continuing to allow wider vehicles to use the road indiscriminately. There have also been instances where some of these large vehicles are causing traffic delays on La Vallee de St. Pierre whilst they attempt to manoeuvre round the tight turn off La Vallee de St. Pierre into Sandybrook Lane. This type of manoeuvre has previously caused damage to the property bordering the corner.

The restriction will not prohibit large vehicles such as refuse collection lorries, road and gulley cleaning vehicles, emergency vehicles and other vehicles delivering to properties on or adjacent to Sandybrook Lane from using the road but will make these larger vehicles using the road as a rat run illegal thus enabling the parish Honorary Police to effectively control this by carrying out random checks.

Policing of this new restriction will be carried out by the St. Lawrence Honorary Police.

As part of the safety improvements being carried out by the Department by Bel Royal School, changes to some of the parking on La Rue de Haut will change, with the loss of a number of spaces and the remaining area being changed from a 12 in 24 hour maximum stay to a 3 hour maximum stay. The changes will complement the safety improvements by Bel Royal School and improve the access for vehicles exiting the school and will enable the Parish to better police the parking. The reduction in maximum stay will facilitate a greater turn over of spaces thus benefitting the School, residents and businesses in the area and will enable the Parish to stop vehicles being left for an undue period of time. A number of these vehicles have been noted as abusing the parking and are not necessarily owned by local residents or people visiting the area. Policing of the new maximum stay parking will be undertaken by St. Lawrence Honorary Police. (Appendix 2)

A new area of prohibition of waiting is to be introduced on La Route de St. Jean following a recommendation by the Road Safety Review Panel. The recommendation was as a result of damage being caused to a roadside wall by vehicular traffic and will enable a safe area for vehicles to pass each other without any further damage being caused. (Appendix 3)

Road Traffic (St. Lawrence) (Jersey) Order 1990

- Schedule 3 Part 1 – Prohibition of waiting:

- Add a new entry after those for La Grande Route de St. Laurent – in the first column “La Route de St. Jean” and in the second column “(Both sides from a point 103 yards south of the junction with La Rue des Billieres to a point 47 yards further south)”
- Add a new entry in column 2 for La Rue de Haut “West side (between its junction with La Vallée de St. Pierre and a point 33 yards further north)”
- Schedule 5 Part 3 – Roads not to be used by vehicles exceeding 6 foot 6 inches in width:
  - Add a new entry after that for Le Mont Cambrai in column one “Sandybrook Lane” and in column two “In a northerly direction from the junction with La Vallee de St. Pierre to its junction with Maison La Cave”.
- Schedule 7 – Duration of parking on certain roads:
  - Remove the entries for La Route de St. Jean in the second column and replace with “West side (from a point 9 yards south of its junction with La Rue des Bilières to a point 17 yards further south)” and “West side (from a point 33 yards south of its junction with La Rue des Bilières to a point 70 yards further south)”
  - Remove the entries for La Rue de Haut “West side (between its junction with La Vallée de St. Pierre and a point 11 Yards south of the exit of Le Clos du Val)” and “West side (between a point 11 yards north of the exit of Le Clos du Val and a point 22 yards south of its junction with La Ruelle Corbel)”.
- Schedule 8 Part 1 – Disc Parking:
  - Add a new entry after that for La Route de L’Eglise – in column 1 “La Rue de Haut” and in column 2 “West side (from a point 33 yards north of the junction with La Vallée de St. Pierre to a point 82 yards further north)”
  - Add a new entry for La Rue de Haut – in column 2 “West side (between a point 11 yards north of the exit of Le Clos du Val and a point 22 yards south of its junction with La Ruelle Corbel)”.

The Road Traffic (St. Lawrence) (Jersey) Order 1990 is administered by the Department for Infrastructure.

Appendix 1:

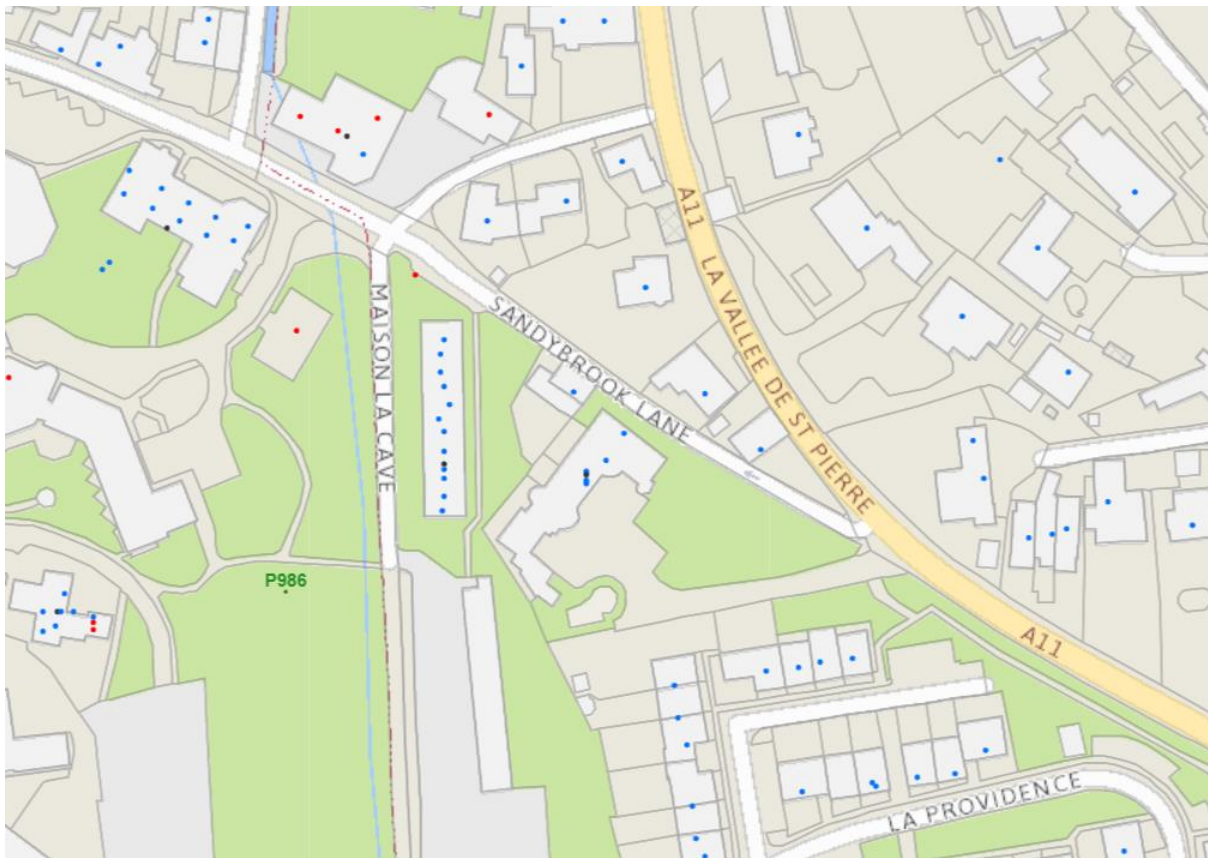

Appendix 2:

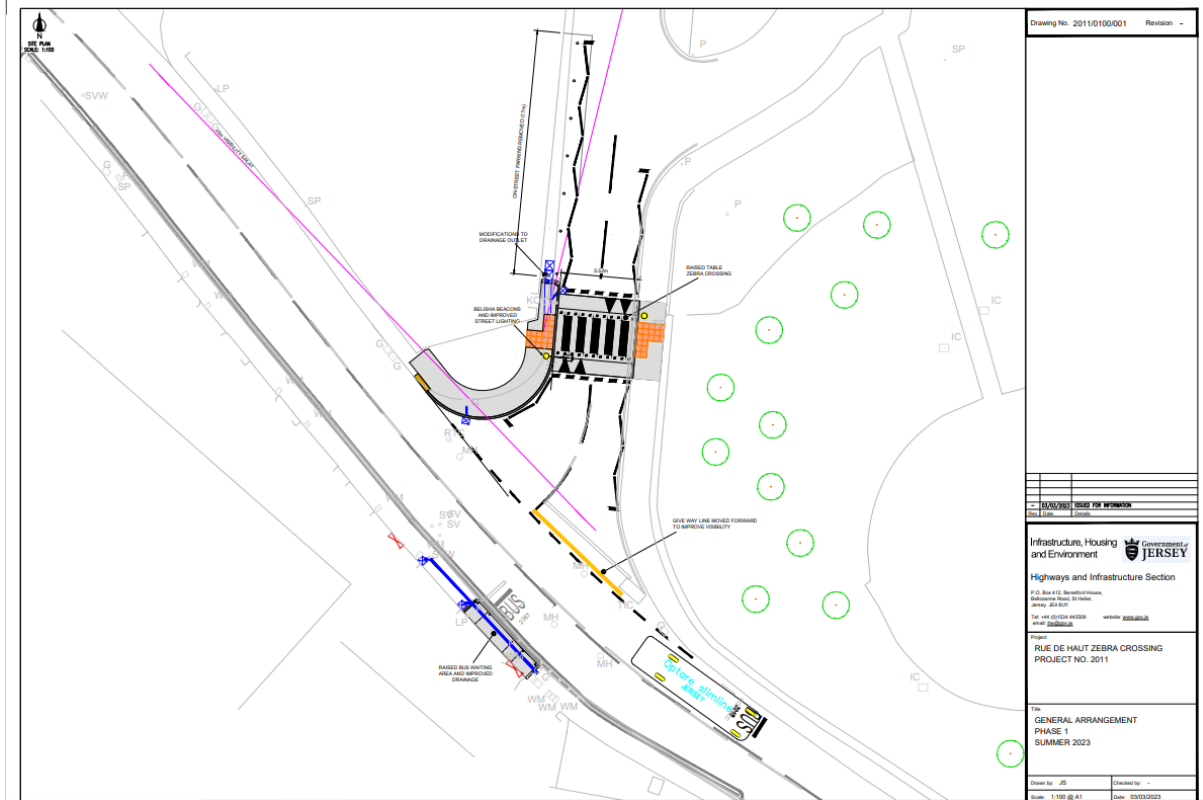

Appendix 3:

